

SEARLE

CARAWAGON DE LUXE



SEARLE

CARAWAGON DE LUXE

*Luxury everyday motoring with
the flavour of adventure.*

The CARAWAGON DE LUXE combines the best of all motoring worlds—Land Rover performance and longevity, Searle-designed comfort and versatility. It provides full day and night accommodation for four, giving complete independence of hotels and restaurants.

The Carawagon is a pleasure to drive—safe and almost indestructible and as easy to handle in busy towns as on country roads. Sportsmen find the Carawagon de luxe the perfect mobile base for shooting and fishing expeditions, and it is equally desirable for Horse Shows or a day at the races.

As a car for everyday use—and a luxury car at that—the Carawagon's unique character appeals to architects, artists, engineers, doctors and vets—anyone, in fact, who has a big mileage to cover, needs room for equipment and a mobile studio or office.

Simple and elegant in design, sturdy and proved in construction, The Carawagon De Luxe is an investment giving excellent 'dividends' for many years to come.

The traditions of restrained good taste, which are so characteristic of all Searle-designed luxury wagons, are evident in the materials and colour treatments used in the Carawagon De Luxe. The Limestone White finish to the coachwork above the waistline matches the alloy elevating roof panels which are stove-enamelled for durability. Solid natural mahogany and diamond-embossed aluminium is used for the interior panelling.

Windows have anodized aluminium frames secured with stainless steel screws. And also typical of the quality which Carawagon build into their vehicles, is the Formica $\frac{3}{4}$ " panelling, with solid mahogany edges with which all vulnerable cabinet surfaces are finished. Handsome African mahogany is used throughout the cabinet interiors. Sleeping-cum-seating-comfort has been scientifically studied and catered for with body-contoured seating upholstered in stretch vynide on aircraft quality foam cushions. Rubber flooring with Latex underlay is in neutral tones.

Another Searle exclusive is the elevating roof—fitted only to Searle custom-built vehicles. This unique single-action coachbuilt roof elevates over an area 8ft x 4ft and has been used and proved for many years by the BBC and various Government departments.



Spacious double-level sleeping



Interior set for dining

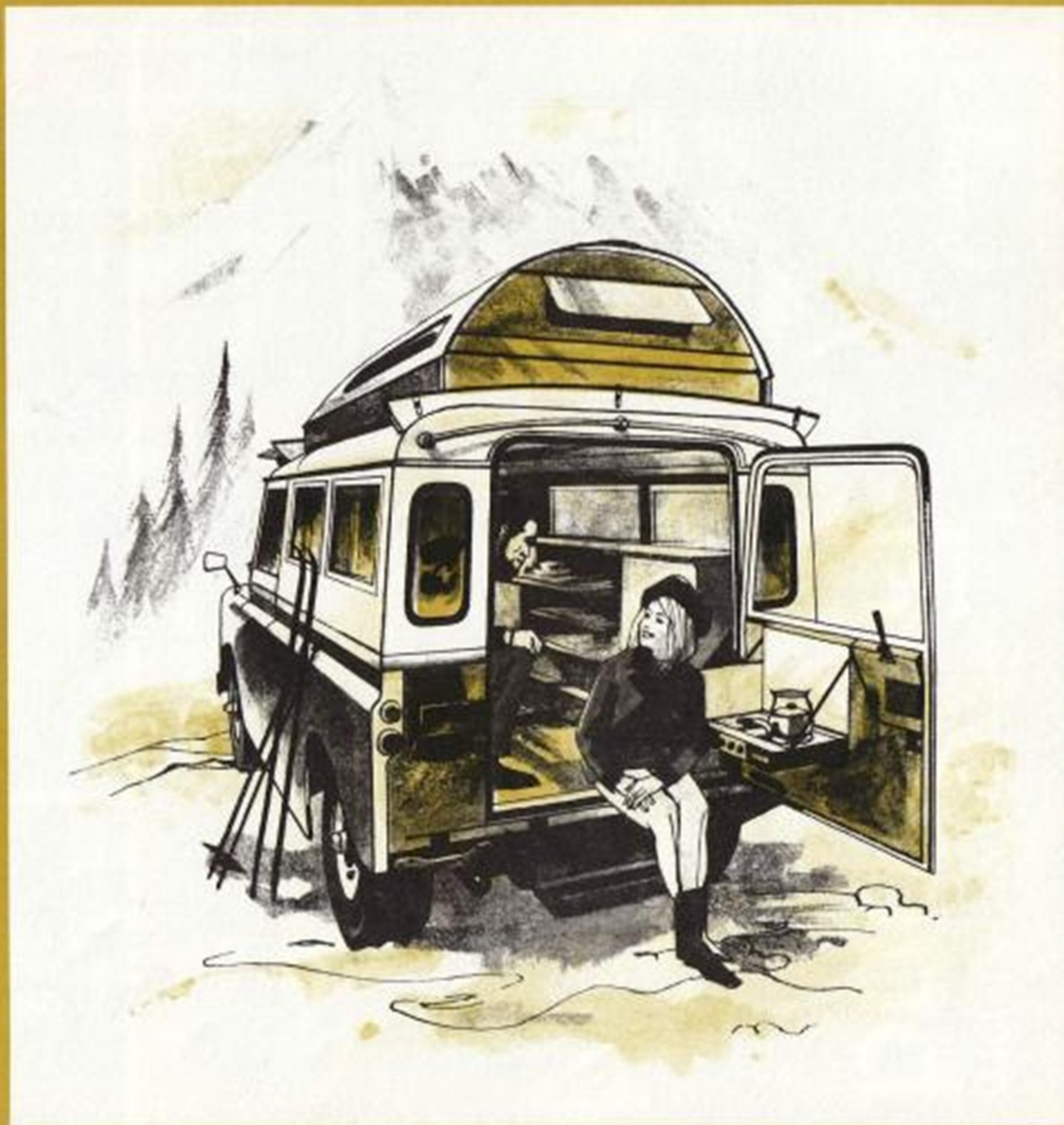

SPECIFICATION

THE CARAWAGON DE LUXE.

FORMICA WORKING SURFACE—14" WIDE X 72" LONG.

STORAGE UNIT WITH SLIDING DOORS IN FORMICA AND MAHOGANY.

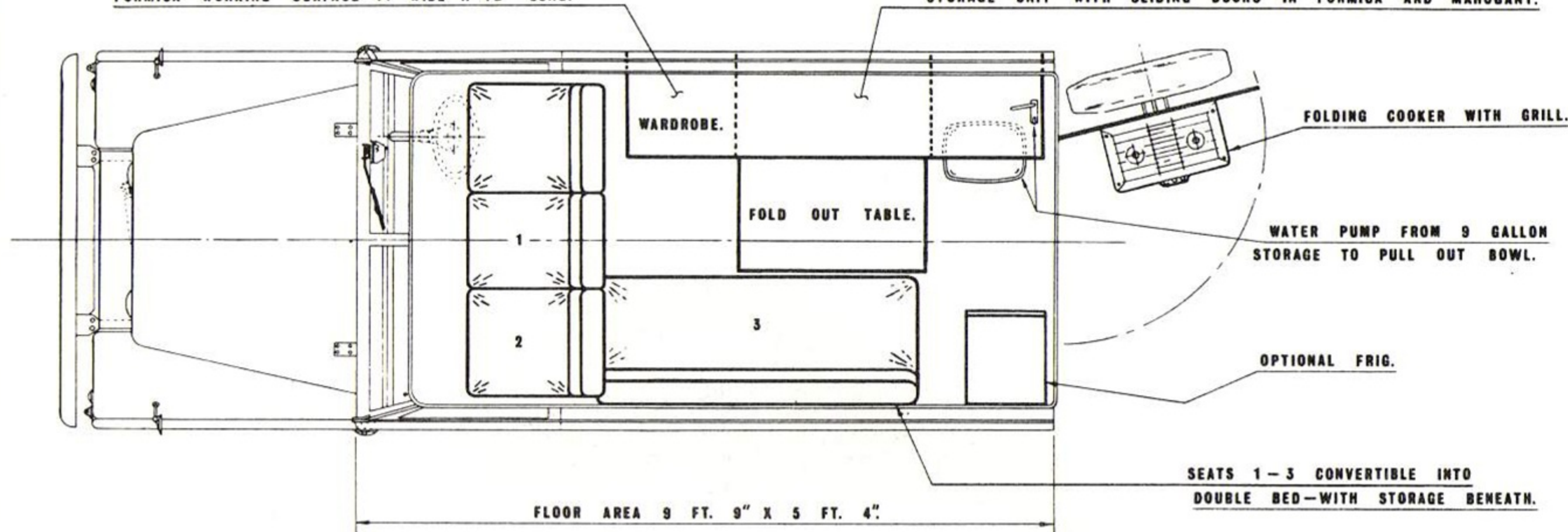

FOR DINING OR TRAVELLING.

TELESCOPIC FRAMED LIVING EXTENSION.

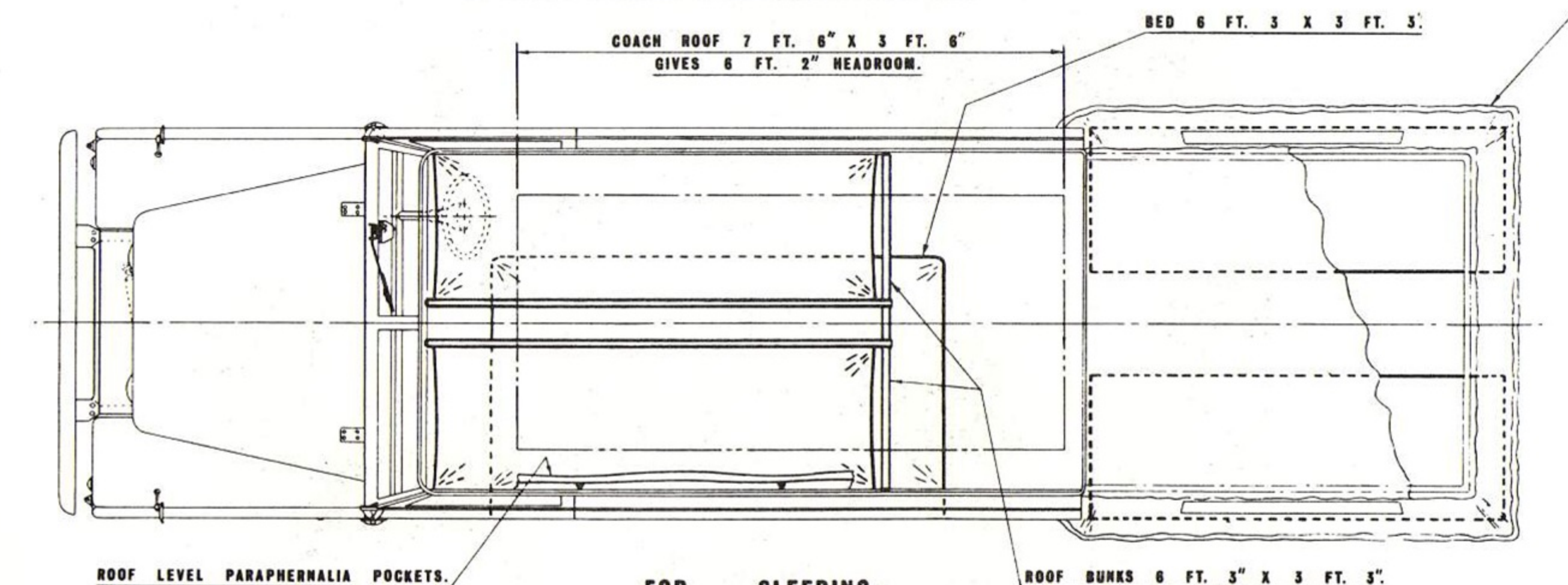

Overall dimensions

Wheelbase 109 ins.
Track 51½ ins.
Ground clearance 9½ ins.
Turning circle 47 ft.
Overall width 66 ins.
Overall length 175 ins.
Overall length
incl. rear mounted spare wheel 181 ins.
Height — roof down 81 ins.
Height — roof elevated 83 ins.

Weight

with spare wheel and tools
1 ton 14 cwt.

ENGINES

4-CYLINDER PETROL

No. of cylinders .. 4.
Bore .. 3.562" (90.49 mm.)
Stroke .. 3.5" (88.9 mm.)
Capacity .. 2,286 c.c. (139.5 cu. in.)
Valve position .. Overhead.
Compression ratio .. 7 : 1
Max. B.H.P. .. 77 at 4,000 rev./min. (Gross).
Max. torque .. 124 lb. ft. (17 mkg.) at 2,500 rev./min. (Gross).

6-CYLINDER PETROL

No. of cylinders .. 6.
Bore .. 3.063" (77.8 mm.)
Stroke .. 3.625" (92.075 mm.)
Capacity .. 2,625 c.c. (160.3 cu. in.)
Valve position .. Overhead inlet, inclined side exhaust.
Compression ratio .. 7.8 : 1 (7.0 : 1 optional).
Max. B.H.P. .. 93 at 4,500 rev./min. (Gross).
Max. torque .. 135 lb. ft. (18.6 mkg.) at 1,750 rev./min. (Gross).

4-CYLINDER DIESEL

No. of cylinders .. 4.
Bore .. 3.562" (90.49 mm.)
Stroke .. 3.5" (88.9 mm.)
Capacity .. 2,286 c.c. (139.5 cu. in.)
Valve position .. Overhead.
Compression ratio .. 23 : 1.
Max. B.H.P. .. 67 at 4,000 rev./min. (Gross).
Max. torque .. 105 lb. ft. (14.5 mkg.) at 1,800 rev./min. (Gross).



Roof elevated



Roof lowered for travelling

QUANTRILL'S
159C, WEST ROAD,
SHOEBURYNESSE,
PET SUPPLIES & D.I.Y.
PHONE 2384

CARAWAGON INTERNATIONAL LTD
THAMES STREET · SUNBURY · MIDDLESEX · ENGLAND
Telephone: Sunbury 85205